

- 3-hole 2-handle basin mixer
- ComfortZone 100
- With pop-up waste 1¼"
- Flow rate: 5 l./min. at 3 bar
- Flow pressure; 1~5 bar (15~70 psi)
- spray type: normal spray

- 2x angle valve 1/2"x3/8"
- basin waste trap

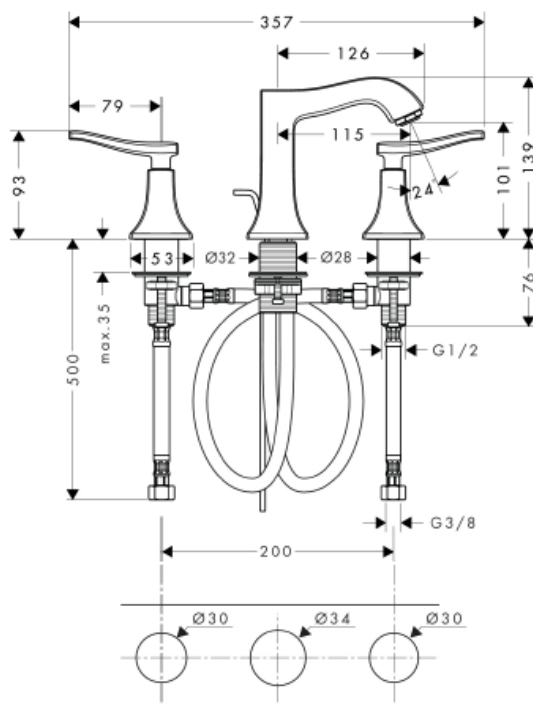

Flushing of pipe must be done before fittings are installed. Failure to do so voids the warranty.  
Follow cleaning instructions and avoid using any harmful chemicals.  
All information is for reference only. Installation shall always be based on the specs provided with actual delivered items.  
For more info, visit **[www.kuysen.com](http://www.kuysen.com)**