

**Above counter basin # 037070..00**

|< 700 mm >|

PuraVida

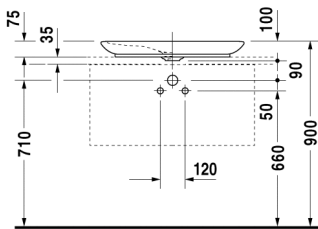
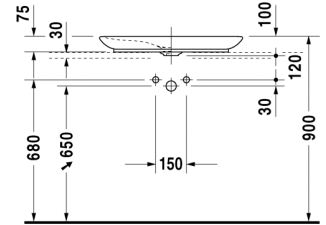
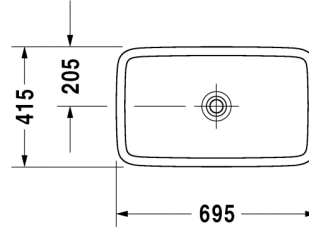

Above counter basin	Dimension	Weight	Order number
without overflow, without tap platform, fixings and ceramic covered slotted waste included, 700 mm			
<b>Colors</b>			
00 White Alpin			
<b>Variant</b>			
700 mm ☒	700 x 420 mm	11,800 kg	037070..00
<b>Accessories</b>			
Design Siphon	-	1,500 kg	005036
Design angle valve	1/2" mm	0,500 kg	003045

All drawings contain the necessary measurements which are subject to standard tolerances. They are stated in mm and are non-binding. Exact measurements, in particular for customised installation scenarios, can only be taken from the finished ceramic piece.

<b>REMINDER:</b>	<b>Pipe flushing must be done before faucets are installed. Failure to do so voids the warranty.</b>
	Do not use cleaners containing abrasive cleansers, ammonia, bleach, acids, waxes, alcohol, solvents or other products not recommended for chrome.
	All information is for reference only, installation shall always be based on the actual product delivered.