

P3 Comforts Handrinse basin # 0716450000 / 0716450060

| < 450 mm > |

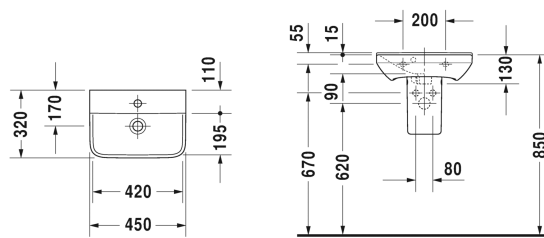

Handrinse basin	Dimension	Weight	Order number
with overflow, with tap platform, overflow clip chrome included, 450 mm			
Colors			
00 White Alpin			
Variant			
●	450 x 320 mm	8,500 kg	0716450000
⊗	450 x 320 mm	8,500 kg	0716450060
Sanitary ceramics with the special WonderGliss surface finish will remain clean and attractive-looking for a long time to come. When ordering WonderGliss please add a "1" as eleventh digit to the model number.			
Suitable products			
Siphon cover for # 071645, 165 x 230 mm	165 x 230 mm		085838

All drawings contain the necessary measurements which are subject to standard tolerances. They are stated in mm and are non-binding. Exact measurements, in particular for customised installation scenarios, can only be taken from the finished ceramic piece.

REMINDER:	Pipe flushing must be done before faucets are installed. Failure to do so voids the warranty.
	Do not use cleaners containing abrasive cleansers, ammonia, bleach, acids, waxes, alcohol, solvents or other products not recommended for chrome.
	All information is for reference only, installation shall always be based on the actual product delivered.